

- 1.** Open the plastic screw to move down the angle bead.

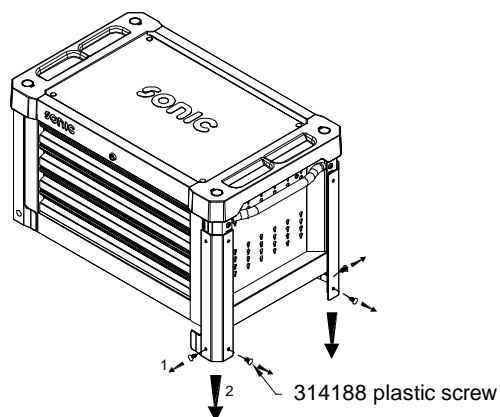

- 2.** Take the handle off from left to right.

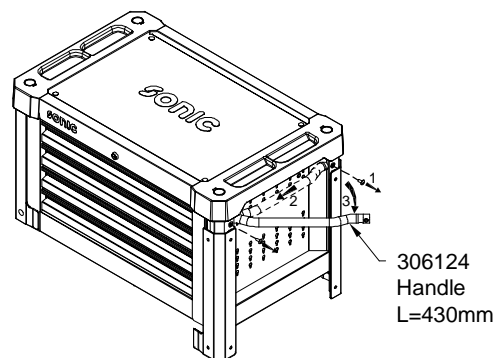

- 3.** Position the handle on the topbox from left to right, tighten the screw securely.

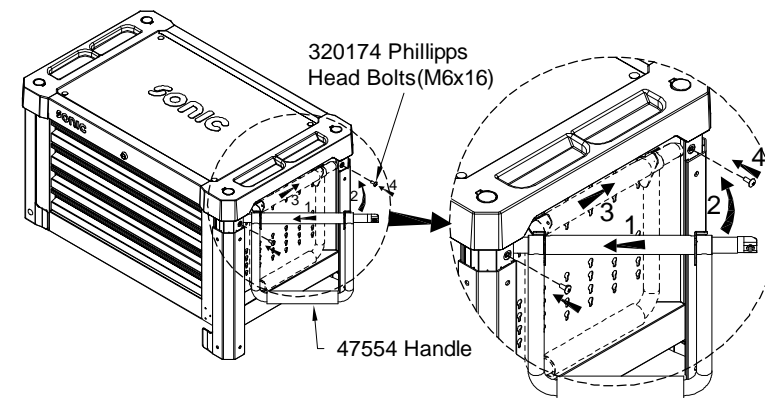

- 4.** Move up the angle bead and tighten the plastic screw.

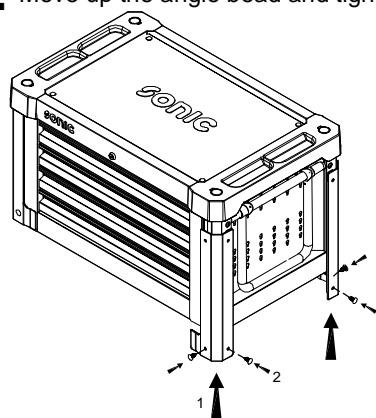

5. INSTALL CASTERS

Carefully lay the topbox on its back, with a soft mat under the back for protection. Position the two locking casters on either the left or right side of the bottom of the cabinet. Insert the carriage bolts through washers, then through the casters and into the bottom of the cabinet. Tighten securely. Repeat for the two free wheeling casters on the other side.

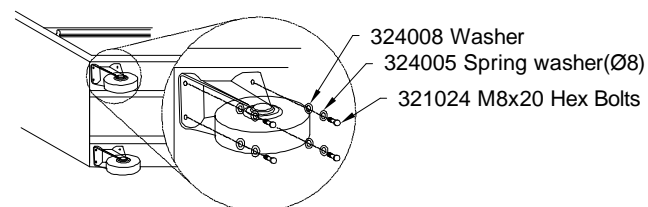

4733014 4DS S9 topbox trolley Ral 7011 Wrinkle

PARTS LIST

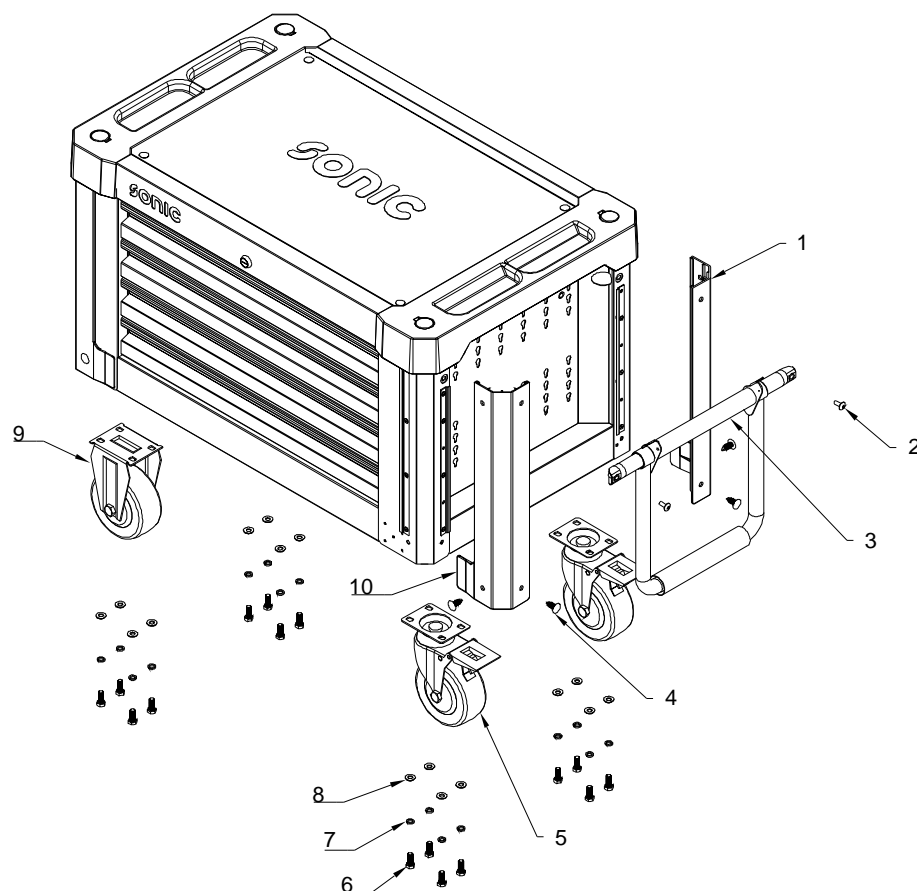

Ref#	Description	Part#	QTY
1	Angle Bead(L)	314202	2 pcs
2	M6x16 Phillipps Head Bolts	320174	8 pcs
3	Handle	47554	1 pc
4	Plastic Screw	314188	8 pcs
5	Swivel Caster	47209S	2 pcs
6	M8x20 Hex Bolts	321024	16 pcs
7	Spring washer(Ø8)	324005	16 pcs
8	Washer	324008	16 pcs
9	Fix Caster	47209F	2 pcs
10	Angle Bead(R)	314203	2 pcs